

# CHARMILL

RESIDENTIAL



**Baker Street, Marylebone NW1**  
**£1,350,000**





Situated on the fourth floor of the prestigious mansion block, Chiltern Court, is this well presented two double bedroom apartment. You enter the property through a spacious hallway, which has ample room to lend itself to a study. Next you will find a large reception room, fully fitted eat-in kitchen, two double bedrooms, a bathroom and a shower room. Furthermore, the apartment has lots of storage space, original floors and the building benefits from a 24 hour porter and a lift.

Chiltern Court is superbly positioned just around the corner from Baker Street station which offers numerous transport links via the Bakerloo, Circle, Hammersmith & City, Jubilee and Metropolitan lines. The wonderful green open spaces of Regent's Park are a short walk away as well as Marylebone High Street, which offers a vast array of fashionable boutiques and restaurants.







Floor Plan

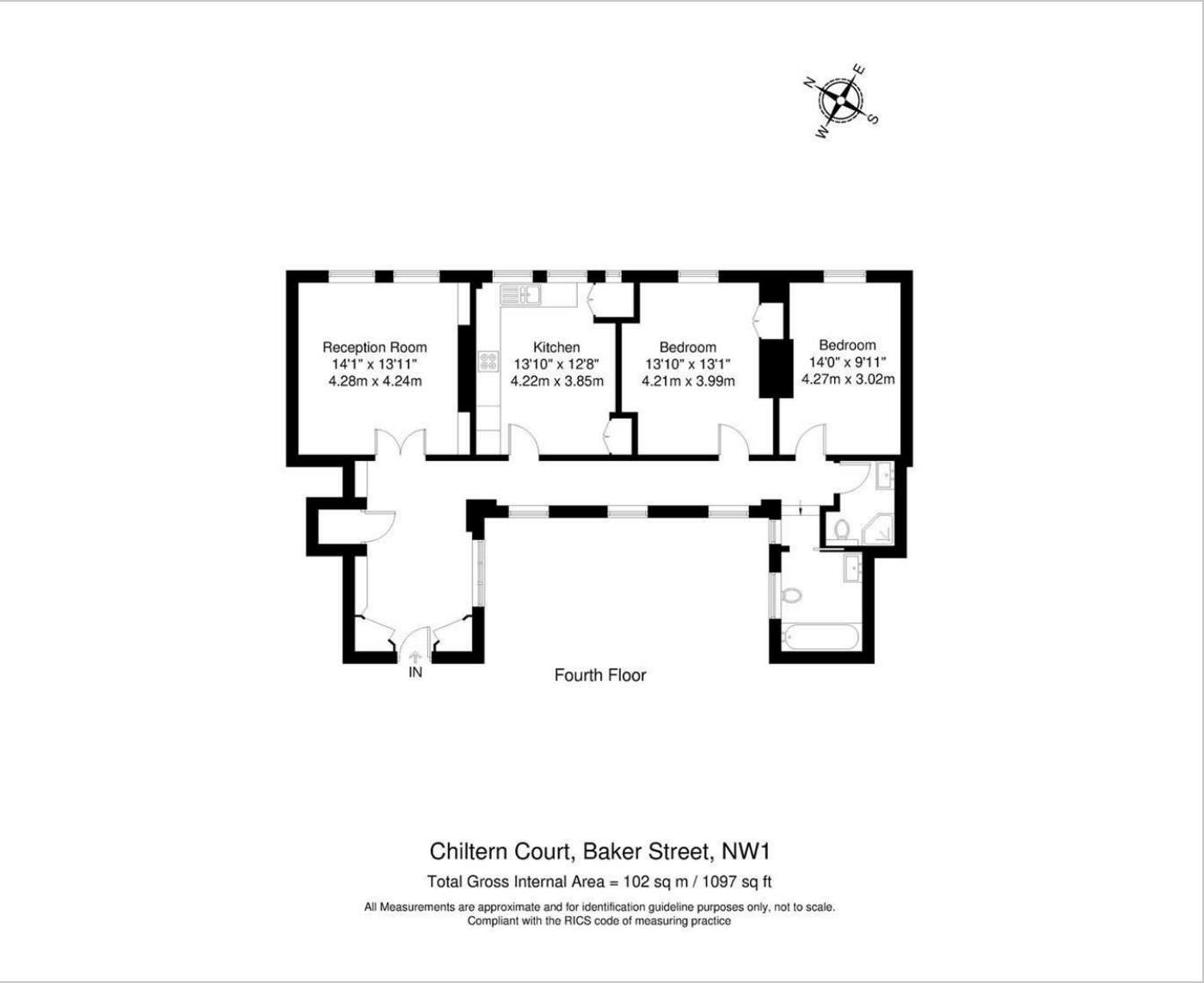

Area Map

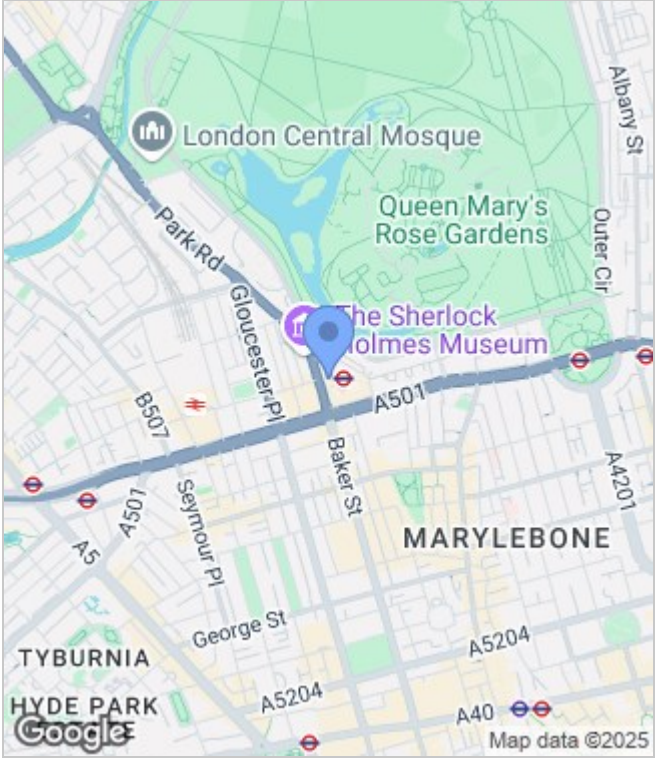

Energy Performance Graph

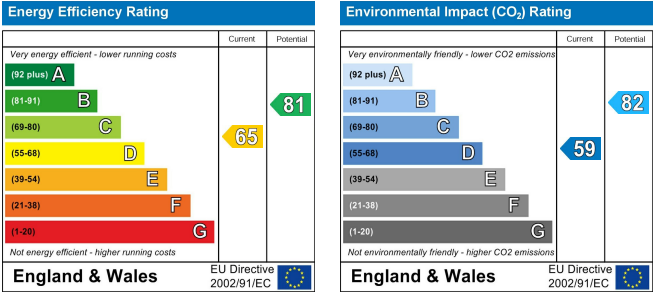

These particulars, whilst believed to be accurate are set out as a general outline only for guidance and do not constitute any part of an offer or contract. Intending purchasers should not rely on them as statements of representation of fact, but must satisfy themselves by inspection or otherwise as to their accuracy. No person in this firms employment has the authority to make or give any representation or warranty in respect of the property.

